

## Ground Floor

Approx. 38.3 sq. metres (411.8 sq. feet)

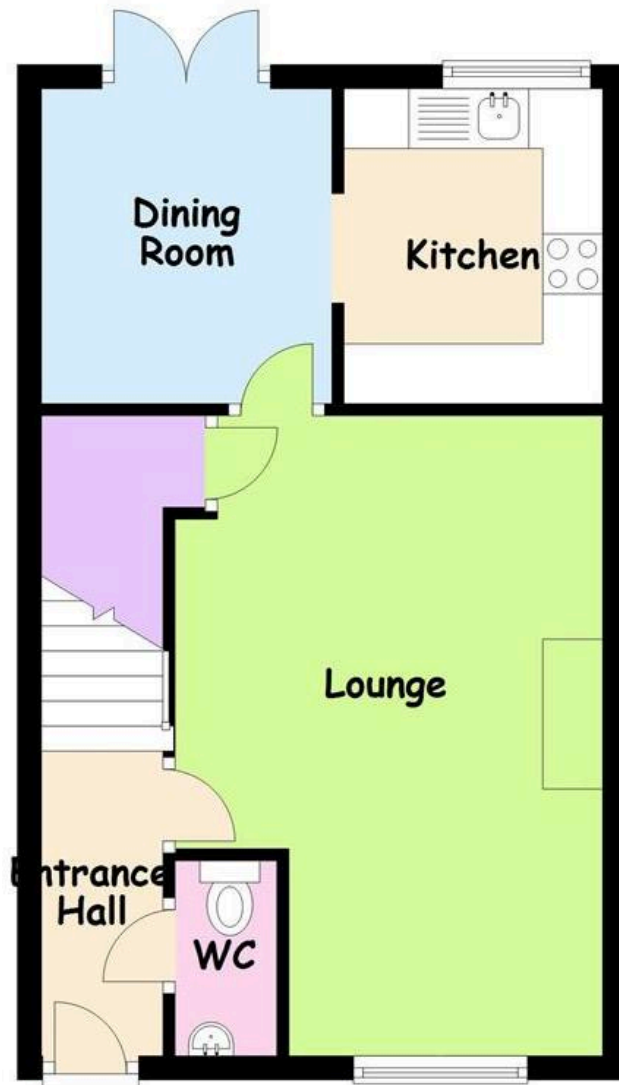

## First Floor

Approx. 38.4 sq. metres (413.6 sq. feet)

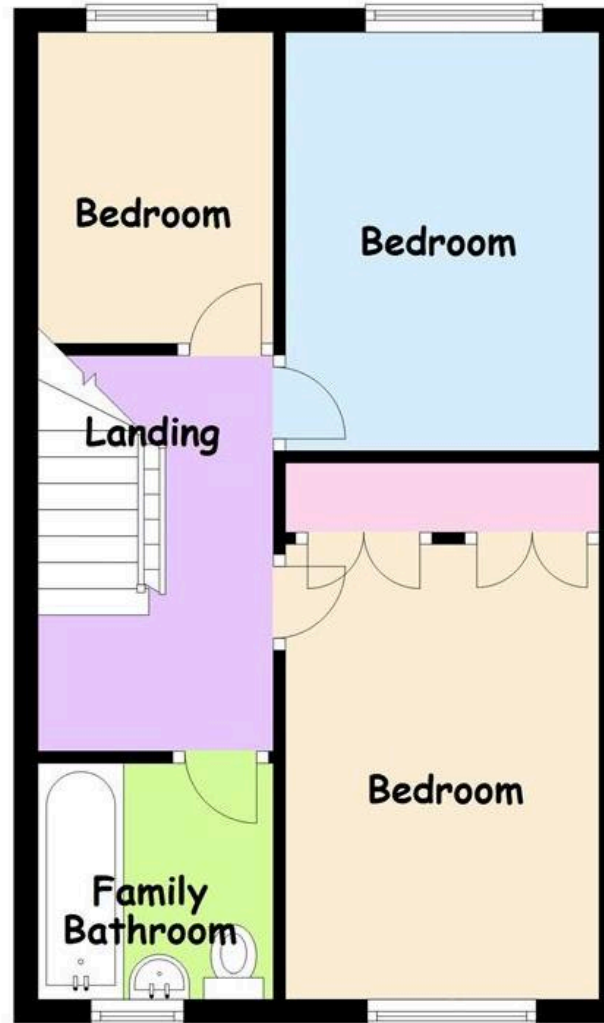

## Second Floor

Approx. 28.3 sq. metres (304.4 sq. feet)



Total area: approx. 105.0 sq. metres (1129.8 sq. feet)